

分譲区画求積図(最終)		図面NO
所在	高崎市上佐野町字寺前437番1、426番1	用紙 A3
縮尺	1/200	作成日 令和5年2月17日
高崎市東町172番地20 TEL 027-323-3952 FAX 027-395-4100	泉司法総合事務所 土地家屋調査士 泉 恭平	

(後退含む)

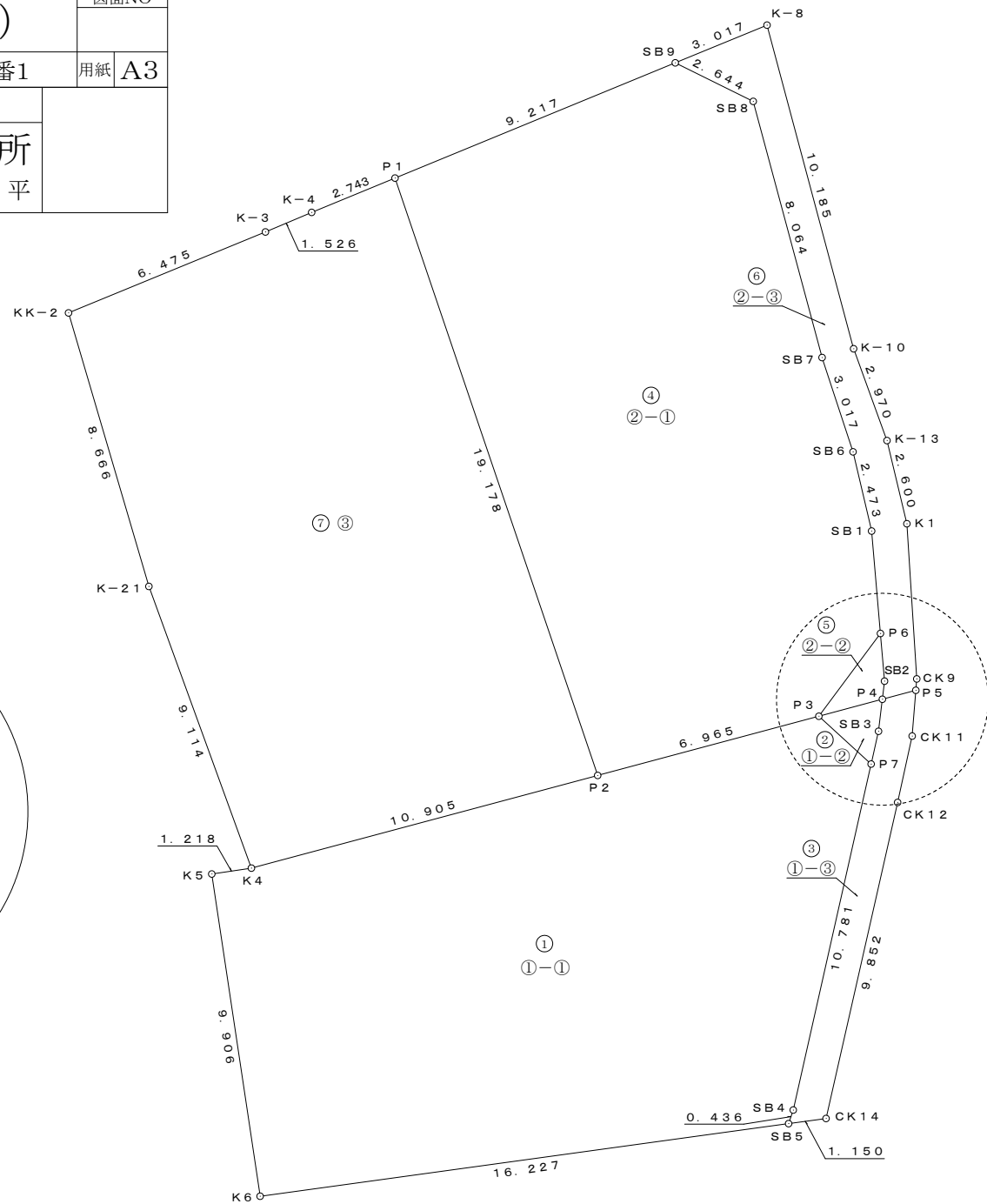
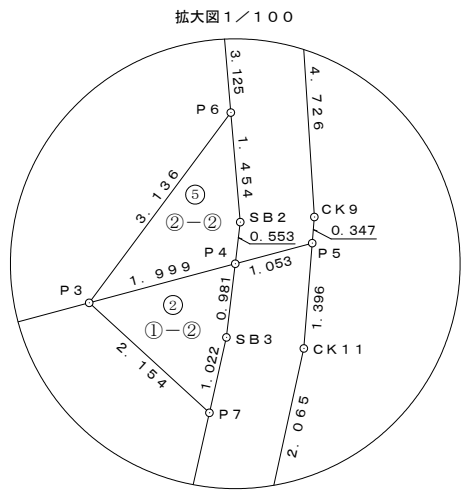

求積表

地番	①	①-①				
NO	X_n	Y_n	$Y_{n+1}-Y_{n-1}$	$X_n \cdot (Y_{n+1}-Y_{n-1})$		
P3	33954.651	-72972.095	-8.319	-282468.741669		
P2	33952.851	-72978.824	-17.264	-586162.019664		
K4	33950.034	-72989.359	-11.740	-398573.399160		
K5	33949.855	-72990.564	0.266	9030.661430		
K6	33940.058	-72989.093	17.548	595580.137784		
SB5	33942.266	-72973.016	16.219	550509.612254		
SB4	33942.679	-72972.874	2.511	85230.066969		
P7	33953.197	-72970.505	0.779	26449.540463		
合計				-404.141593		
合計面積				202.0707965		
地積				202.07	m^2	

地番	②	①-②				
NO	X_n	Y_n	$Y_{n+1}-Y_{n-1}$	$X_n \cdot (Y_{n+1}-Y_{n-1})$		
P4	33955.168	-72970.163	-1.815	-61628.629920		
P3	33954.651	-72972.095	-0.342	-11612.490642		
P7	33953.197	-72970.505	1.815	61625.052555		
SB3	33954.194	-72970.280	0.342	11612.334348		
合計				-3.733659		
合計面積				1.8668295		
地積				1.86	m^2	

総合計面積	648.8282220 m^2
-------	-------------------

地積一覧表

①-①	202.07 m^2
①-②	1.86 m^2
①-③	13.71 m^2
②-①	203.83 m^2
②-②	2.02 m^2
②-③	23.26 m^2
③	202.04 m^2

地番	③	①-③			
NO	X_n	Y_n	$Y_{n+1}-Y_{n-1}$	$X_n \cdot (Y_{n+1}-Y_{n-1})$	
P5	33955.440	-72969.145	-0.907	-30797.584080	
P4	33955.168	-72970.163	-1.135	-38539.115680	
SB3	33954.194	-72970.280	-0.342	-11612.334348	
P7	33953.197	-72970.505	-2.594	-88074.593018	
SB4	33942.679	-72972.874	-2.511	-85230.066969	
SB5	33942.266	-72973.016	0.998	33874.381468	
CK14	33942.422	-72971.876	3.317	112587.013774	
CK12	33952.031	-72969.699	2.620	88954.321220	
CK11	33954.048	-72969.256	0.554	18810.542592	
合計				-27.435041	
合計面積				13.7175205	
地積				13.71	m^2

地番	④	②-①			
NO	X_n	Y_n	$Y_{n+1}-Y_{n-1}$	$X_n \cdot (Y_{n+1}-Y_{n-1})$	
SB9	33974.516	-72976.463	-10.897	-370220.300852	
P1	33971.012	-72984.989	-2.361	-80205.559332	
P2	33952.851	-72978.824	12.894	437788.060794	
P3	33954.651	-72972.095	8.602	292077.907902	
P6	33957.167	-72970.222	1.605	54501.253035	
SB1	33960.281	-72970.490	-0.834	-28322.874354	
SB6	33962.689	-72971.056	-1.507	-51181.772323	
SB7	33965.556	-72971.997	-3.036	-103119.428016	
SB8	33973.344	-72974.092	-4.466	-151724.954304	
合計				-407.667450	
合計面積				203.8337250	
地積				203.83	m^2

地番	⑤	②-②			
NO	X_n	Y_n	$Y_{n+1}-Y_{n-1}$	$X_n \cdot (Y_{n+1}-Y_{n-1})$	
P6	33957.167	-72970.222	-1.998	-67846.419666	
P3	33954.651	-72972.095	0.059	2003.324409	
P4	33955.168	-72970.163	1.998	67842.425664	
SB2	33955.718	-72970.097	-0.059	-2003.387362	
合計				-4.056955	
合計面積				2.0284775	
地積				2.02	m^2

地番	⑥	②-③			
NO	X_n	Y_n	$Y_{n+1}-Y_{n-1}$	$X_n \cdot (Y_{n+1}-Y_{n-1})$	
K-8	33975.662	-72973.672	-5.425	-184317.966350	
SB9	33974.516	-72976.463	-0.420	-14269.296720	
SB8	33973.344	-72974.092	4.466	151724.954304	
SB7	33965.556	-72971.997	3.036	103119.428016	
SB6	33962.689	-72971.056	1.507	51181.772323	
SB1	33960.281	-72970.490	0.834	28322.874354	
P6	33957.167	-72970.222	0.393	13345.166631	
SB2	33955.718	-72970.097	0.059	2003.387362	
P4	33955.168	-72970.163	0.952	32325.319936	
P5	33955.440	-72969.145	1.046	35517.390240	
CK9	33955.786	-72969.117	-0.272	-9235.973792	
K1	33960.503	-72969.417	-0.905	-30734.255215	
K-13	33963.032	-72970.022	-1.621	-55054.074872	
K-10	33965.823	-72971.038	-3.650	-123975.253950	
合計				-46.527733	
合計面積				23.2638665	
地積				23.26	m^2

地番	⑦	③			
NO	X_n	Y_n	$Y_{n+1}-Y_{n-1}$	$X_n \cdot (Y_{n+1}-Y_{n-1})$	
P1	33971.012	-72984.989	-8.702	-295615.746424	
K-4	33969.969	-72987.526	-3.943	-133943.587767	
K-3	33969.374	-72988.932	-7.396	-251237.490104	
KK-2	33966.913	-72994.922	-3.546	-120446.673498	
K-21	33958.598	-72992.478	5.563	188911.680674	
K4	33950.034	-72989.359	13.654	463553.764236	
P2	33952.851	-72978.824	4.370	148373.958870	
合計				-404.094013	
合計面積				202.0470065	
地積				202.04	m^2